

DOCK BUMPERS AND PACKERS

ULTRA HIGH MOLECULAR WEIGHT POLYETHYLENE FACED DOCK BUMPERS

Part Number: **UHMWPE.3010**

MATERIAL: UHMWPE/SBR RUBBER COMPOUND

Weight: 23.3Kg

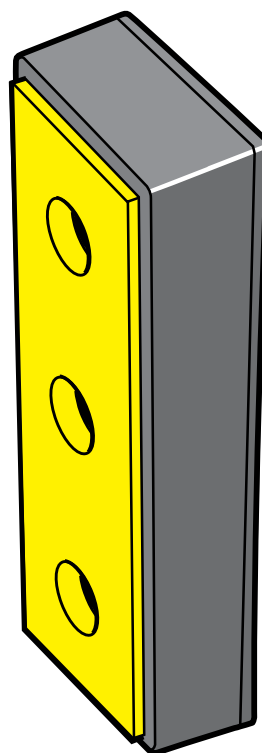
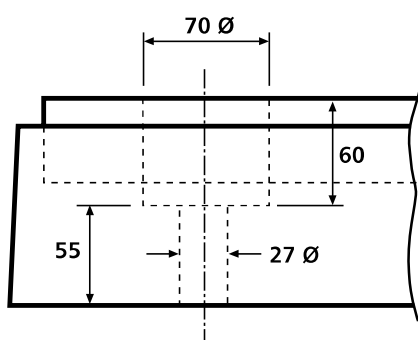
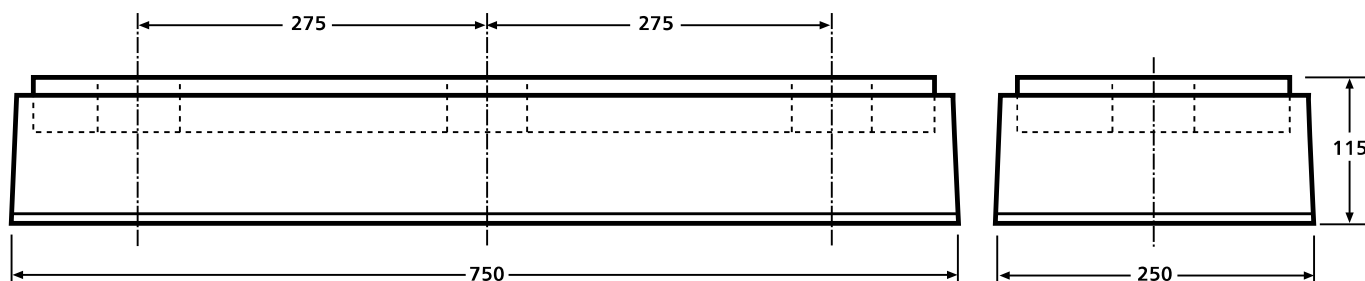
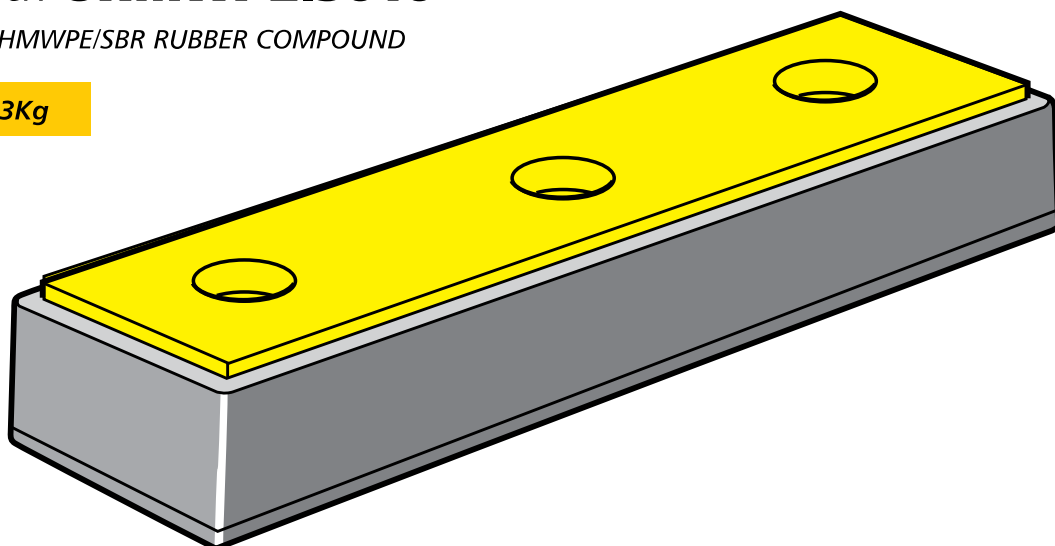

Tough High Molecular weight PE front to withstand daily punishment.

High visibility to help drivers align trailers more accurately.

Rubber backing to allow compression and save direct load onto loading bay.

Easy to fit onto existing fixtures - same hole centres as current industry standard 750mm bumpers